



*jordan fishwick*

**WILMSLOW**  
Lindfield Estate South



# Lindfield Estate South, Wilmslow, SK9 5JD

£1,495 PCM



## The Property

### AVAILABLE NOW PART FURNISHED - VIEWING ESSENTIAL

Lindfield Estate South has grown in popularity over recent years as it is situated in a quiet position to the South of Wilmslow town centre.

This no through road has become sought after by professional couples and growing families as the houses offer good sized accommodation within walking distance of Wilmslow town centre and the train station and the properties are in the catchment area of highly regarded local schools.

With local shops on the doorstep and Manchester International Airport, A34 bypass and motorway networks all only a short drive away this three bedroom semi detached is definitely worth viewing. Entrance hall, lounge with feature fireplace, modern dining kitchen with range cooker, fridge freezer, washing machine, dishwasher and door to enclosed sunny rear garden with decked area.

To the first floor two double bedrooms, third large single small double bedroom, family bathroom with shower over bath.

Southerly enclosed rear garden, off road parking to the front for 1 car, quiet cul-de-sac location

Contact Wilmslow 01625 536300 £1495.00 pcm

COUNCIL TAX C

EPC D

## Directions

SK9 5JD



- THREE BEDROOMS
- SOUTH WILMSLOW LOCATION
- WALKING DISTANCE OF TRAIN STATION
- SUNNY REAR GARDEN
- OFF ROAD PARKING
- COUNCIL TAX C
- EPC D

Postcode - SK9 5JD

EPC Rating - D

Floor Area - sq ft

Local Authority - Cheshire East

Council Tax - C



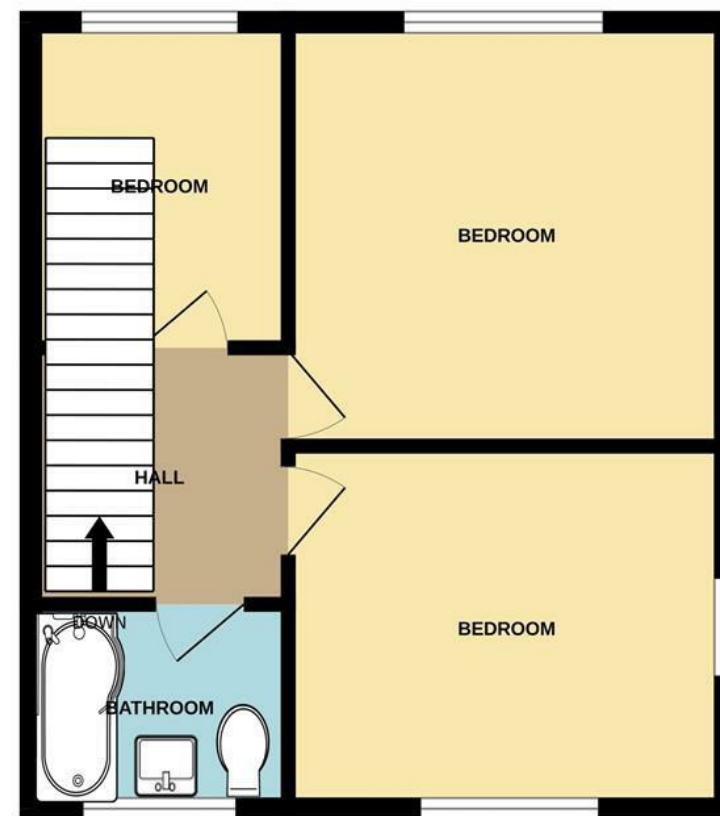
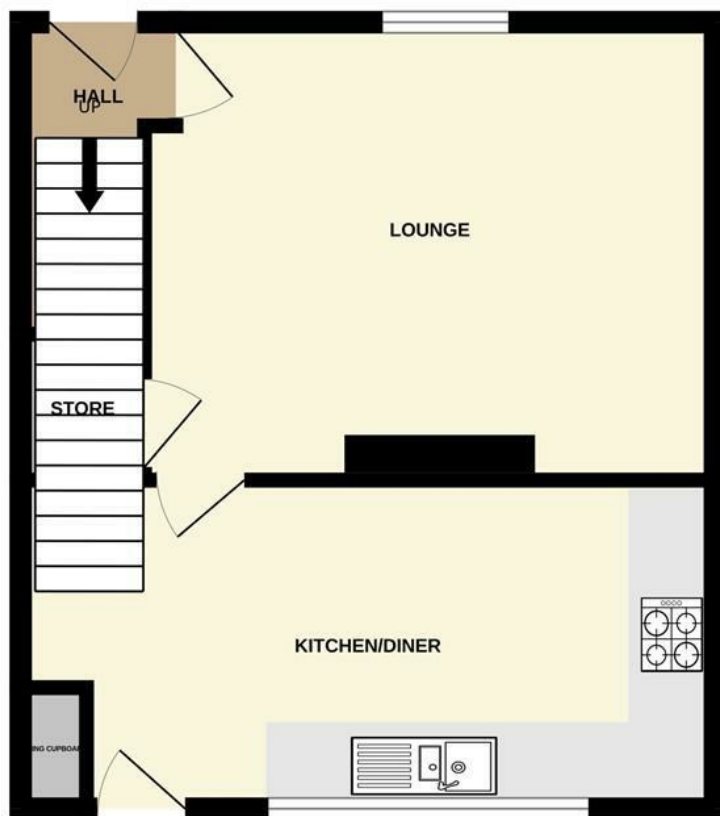

These particulars are believed to be accurate but they are not guaranteed and do not form a contract. Neither Jordan Fishwick nor the vendor or lessor accept any responsibility in respect of these particulars, which are not intended to be statements or representations of fact and any intending purchaser or lessee must satisfy himself by inspection or otherwise as to the correctness of each of the statements contained in these particulars. Any floorplans on this brochure are for illustrative purposes only and are not necessarily to scale.

Offices at: Chorlton, Didsbury, Disley, Hale, Glossop, Macclesfield, Manchester Deansgate, Manchester Whitworth Street, New Mills, Sale, Wilmslow and Withington

01625 536300